



10 St. Francis Road, Salisbury, Wiltshire, SP1 3QS

£1,400 PCM

Situated in a sought-after location, a good sized and well-presented extended 3 bedroom family home with large garage. UNFURNISHED

This well-presented 3-bedroom property is located in a sought-after location. The property comprises an entrance lobby, entrance hall, cloakroom, kitchen, sitting room, dining room, and family room. Upstairs there are three bedrooms, two doubles and one single which all come with wardrobes, additionally there is a re-fitted modern bathroom. The property has gas-fired central heating, double glazing, a private driveway, a large garage as well a garden with a shed. The property is Unfurnished.

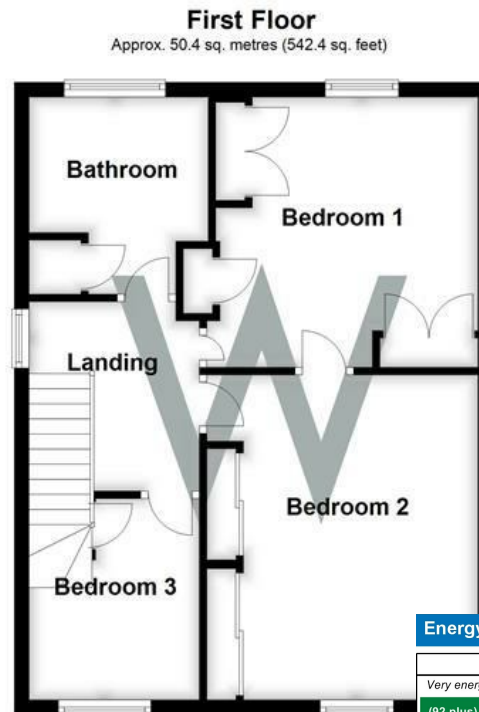
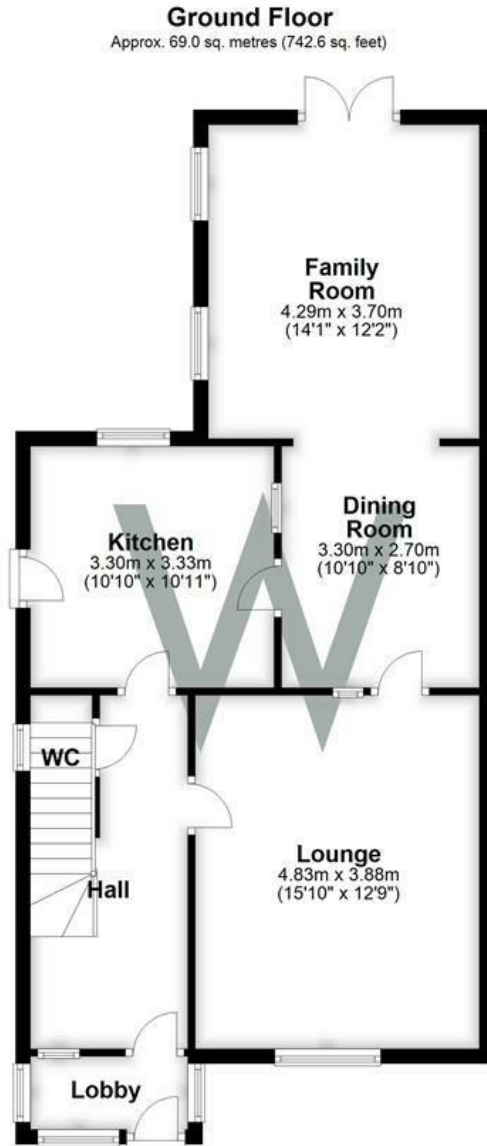

Total area: approx. 119.4 sq. metres (1285.0 sq. feet)

Energy Efficiency Rating		
	Current	Potential
Very energy efficient - lower running costs		
(92 plus) A		
(81-91) B		
(69-80) C		
(55-68) D		
(39-54) E		
(21-38) F		
(1-20) G		
Not energy efficient - higher running costs		
	64	77
England & Wales <small>EU Directive 2002/91/EC</small>		



WHITES
 Castle Chambers, 47 Castle Street,
 Salisbury, Wiltshire, SP1 3SP
 01722 336422
www.hwwhite.co.uk
residential-sales@hwwhite.co.uk

